

Front flange type 10

Shaft form E

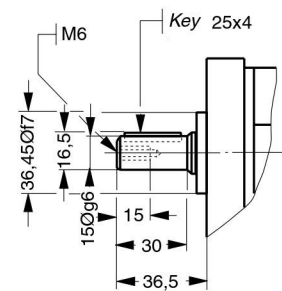
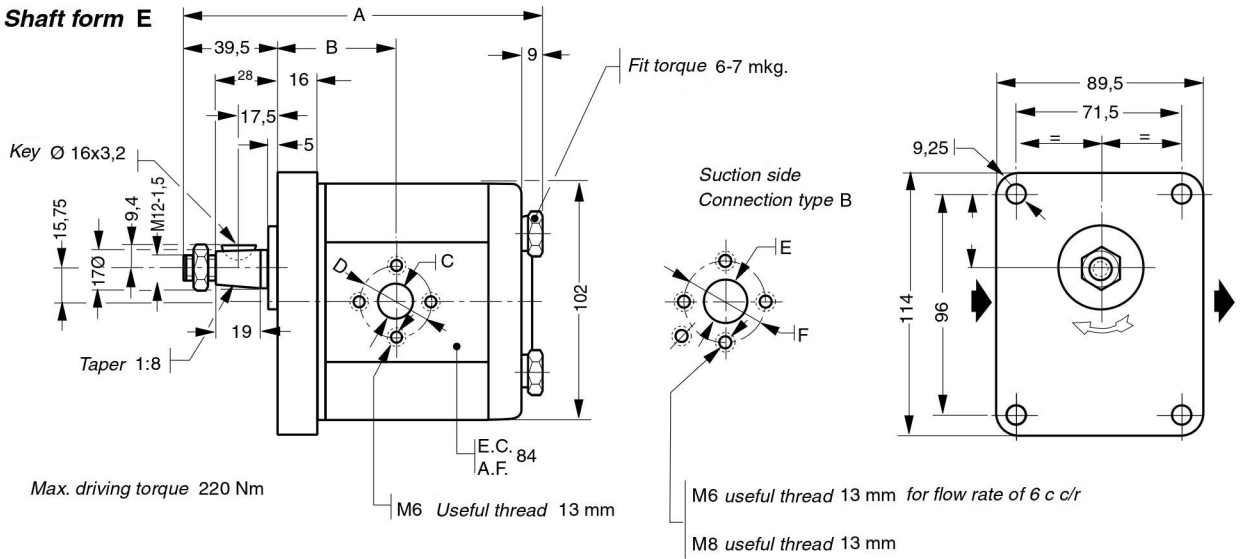

Shaft form R

Max. driving torque 50 Nm

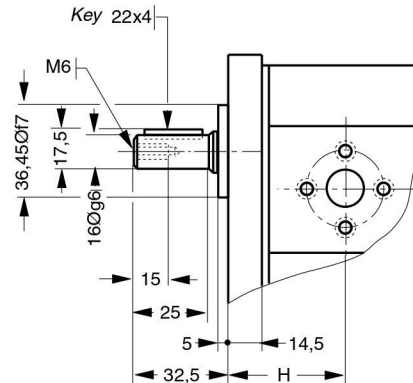

Shaft form C

Front Flange type 31

Model	Displacement cc/r	A	B	H	Pressure		Suction		Weight kg
					C	D	E	F	
1L9D▲10B	6	132,8	42,5	39,5	13,5	30	13,5	30	32
1L12D▲10B	8	136	44,6	41,6	15		20	40	3,5
1L16D▲10B	10,6	140,6	49	46					3,9
1L22D▲10B	14,6	147,3							4,3
1L27D▲10B	18	153	56,5	53,5					4,8
1L35D▲10B	23,3	162							

In the reversible pumps, threaded ports available "R" only, both ports same dimension that corresponds to the suction dimension.

The drawing above shows a pump turning clockwise. For anti-clockwise rotation sense, replace "D" by "I", in which case suction and pressure ports shall be inverted.